

Burbage Urban Event – 31 Oct 2020

Covid-19 Measures:

This event is organised in accordance with all BOF Covid-19 precautions.

We are more than usually keen that there is not a build-up of people in the start and finish area as it is very plainly visible to residents and road users and we wish to avoid any unwarranted attention.

In particular, please:

- Do not attend if you have Covid symptoms, have been close to someone who has or have been asked to isolate
- Do not arrive earlier than necessary to get to the Start for your start time. Leave soon after downloading
- Keep 2m distance from other competitors and officials
- Do not form groups of more than 6 people and do not mingle between groups
- There is no key or clothing dump
- Do not congregate in the Start and Finish area which are co-located
- You may well use many jitties on your course. We ask you to be particularly mindful of members of the public when using them.
- Download will be stationed a few metres from the finish punch. Please queue at 2m distance.

Responsibility: by participating you agree to take responsibility for your own safety.

Parking

- There are 45 spaces in the event car park at the council offices which are about 450m from start/finish. Parking here is reserved for competitors and will open at 10.00 and close at 14.00 prompt.
- There is free 2 hour limited customer car parking available in the retail units opposite which you will walk past or through on the way to the start.
- The station car park, which you will walk through, is the nearest to the start and it will be largely empty on a Saturday. Parking here costs £3.
- Do not park in the residential streets close to start and finish or anywhere else on the south side of the railway line.

Route to Start

Make your way past Tesco to Hinckley railway station and cross over the footbridge from where the route, approx. 250m, to the start will be taped. Tesco is plainly visible from parking. The footbridge is narrow and other pedestrians might be sensitive regarding Covid precautions so please take care when crossing and, if possible, wear a mask.

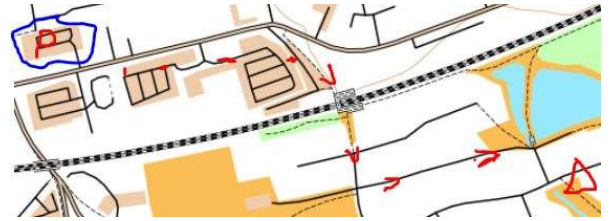

Walk through the very large open area behind the houses. This area is ideal for warming up and is where you should wait if you arrive before your start time. The Start and Finish are immediately across the road from this area. Only cross the road to the start a couple of minutes before your start time.

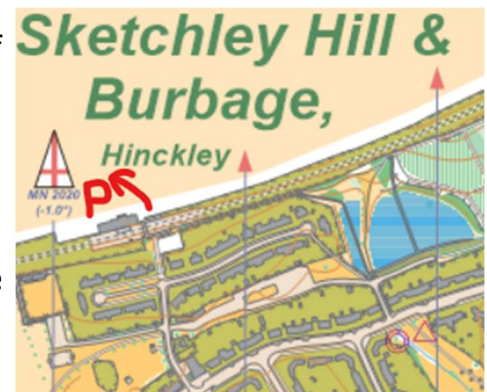

The Start and Finish

There will be a maximum of two starters per minute with plenty of free slots, so you do not need to arrive early as a precaution. On finishing, please download and then immediately cross the road and return to

MapRun

We hope many of you running the Medium and Long courses will also carry your phone (in addition to your SI-card) and use MapRun F or G since we are very interested in the comparison. It will also allow you to see everyone's time and tracks immediately on their finish.

The MapRun courses will be PIN controlled and the PINs will be available in the start area. The courses will be available in the Leicestershire MapRun folder as Burbage Village Medium and Long. The start punch will be about 15m away from the start line to ensure that MapRun does not register the start while you are waiting on the line.

Event results will be purely based on SI timing. Maprun has been tested several times on both courses so it will be a great opportunity for regular users and those unfamiliar with the App to give it a fail-safe try-out in anger.

Enjoy your run

See you all next Saturday and, most importantly, enjoy your run. We look forward to seeing you all back here again as we hope to be staging a two-day event in Hinckley and Burbage in the next year or so.